

// एकमेका साह्य करु , अवघे धरु सुपथ //
GOLDEN JUBILEE YEAR-2021-22

Estd.: 1972

Ph: (02478) 276036



Shri. Shivaji Shikshan Prasarak Mandal, Barshi's
KARMAVEER MAMASAHEB JAGDALE MAHAVIDYALAYA, WASHI
Tq. Washi, Dist. Osmanabad, Maharashtra - 413503
(ARTS, SCIENCE & COMMERCE)



4.1.2 The Institution has adequate facilities for cultural activities, sports, games (indoor, outdoor), gymnasium, yoga centre etc.



Latitude: 18.546185
Longitude: 75.765801
Elevation: 726.9 m
Accuracy: 3.8 m
Time: 09-03-2021 11:25
Note: Indoor Gymnasium

Gymnasium



I/C Principal
Karmaveer Mamasahab Jagdale
Mahavidyalaya, Washi.



Auditorium Hall (235.69 SQM)

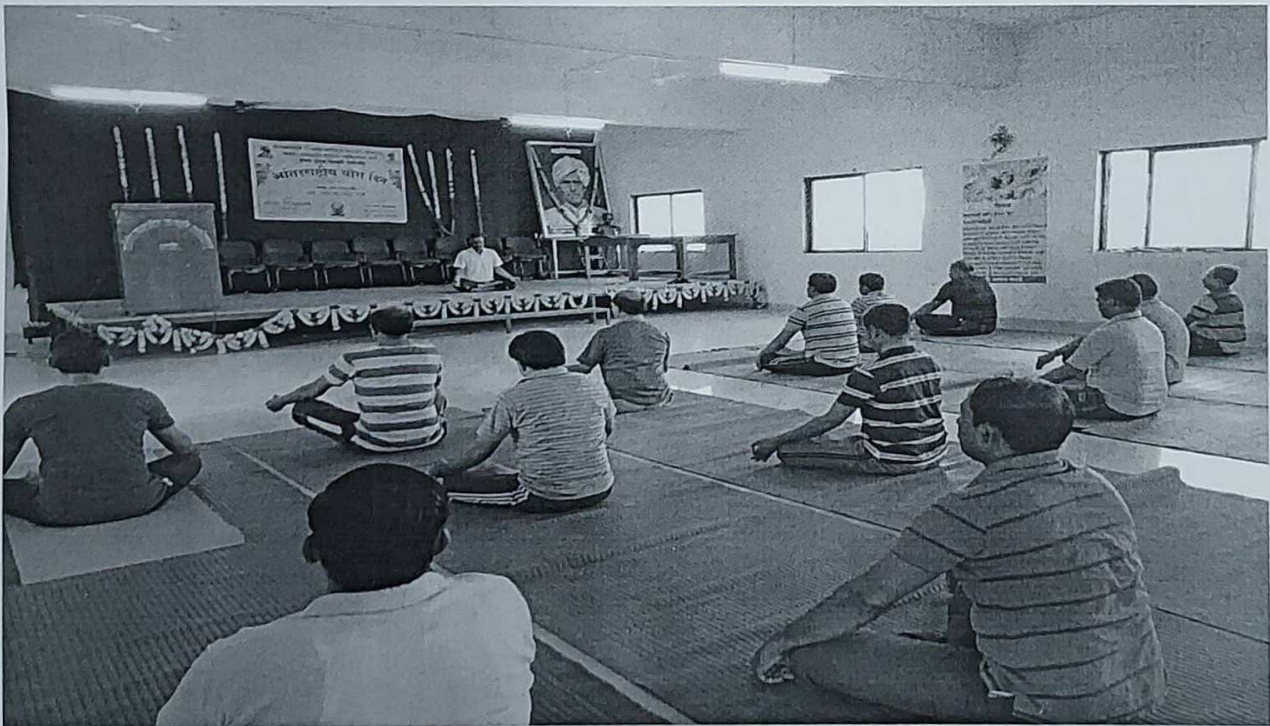

International Yoga Day



**I/C Principal
Karmaveer Mamasheb Jagdale
Mahavidyalaya, Washi.**

Karmaveer Mamasahab Jagdale Mahavidyalaya, Washi.
Department of Physical Education
(400Mtr.) ATHLETICS TRACK

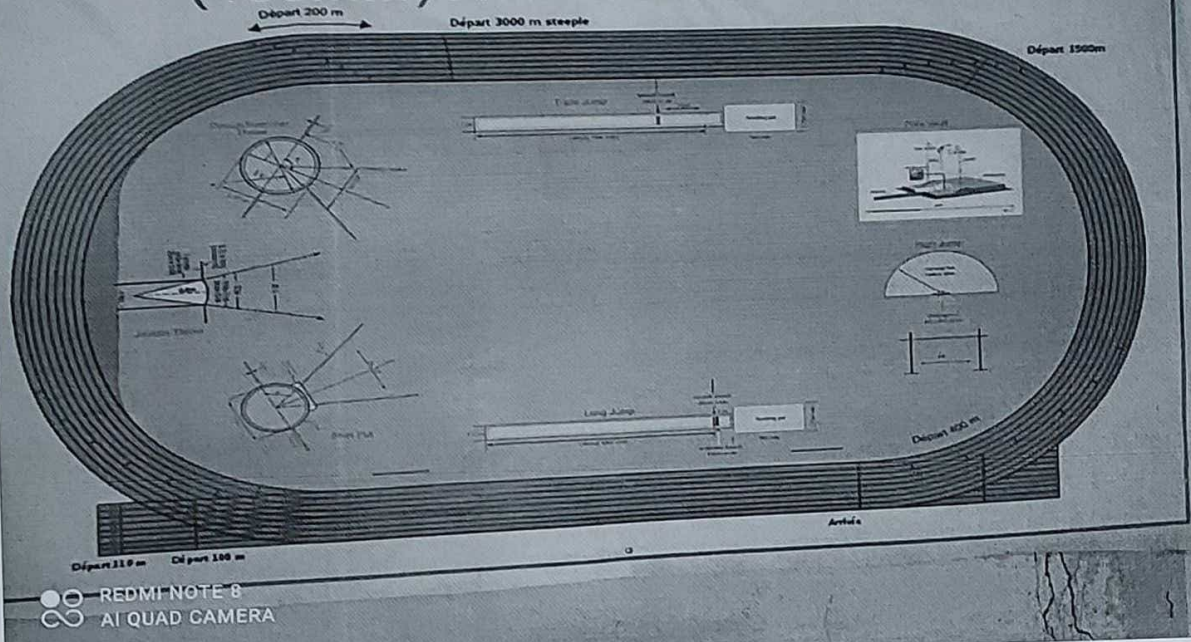

REDMI NOTE 8
 AI QUAD CAMERA

Athletics Track



Latitude: 18.54672
 Longitude: 75.764936
 Elevation: 726.55±28 m
 Accuracy: 51.9 m
 Time: 07-08-2021 13:19
 Note: 400 meter running track

Powered by NoteCam

Running Track



[Signature]
I/C Principal
Karmaveer Mamasahab Jagdale
Mahavidyalaya, Washi.



Latitude: 18.546484
Longitude: 75.76497
Elevation: 726.32±28 m
Accuracy: 39.7 m
Time: 07-08-2021 13:15
Note: 400 meter running track

Running Track



Latitude: 18.54655
Longitude: 75.76499
Elevation: 726.5±28 m
Accuracy: 20.0 m
Time: 07-08-2021 13:17
Note: 400 meter running track

Powered by NoteCam

Running Track



I/C Principal
Karmaveer Mamasahab Jagdale
Mahavidyalaya, Washi.



Latitude: 18.54655
Longitude: 75.76499
Elevation: 726.5128 m
Accuracy: 20.0 m
Time: 07-08-2021 13:17
Note: 400 meter running track

Powered by NITEL/ATI

Running Track



Latitude: 18.546532
Longitude: 75.765043
Elevation: 726.57128 m
Accuracy: 47.2 m
Time: 07-08-2021 13:17
Note: 400 meter running track

Powered by NITEL/ATI

Running Track





I/C Principal
Karmaveer Mamasheeb Jagdale
Mahavidyalaya, Washi,

Shri Shivaji Shikshan Prasarak Mandal Barshi's

**KARMAVEER MAMASAHEB JAGDALE
MAHAVIDYALAYA, WASHI****Sports Department Equipment List**

Sr.No	Equipments Name	Quantity
1	Volleyball Passing	00
2	Volleyball Net	01
3	Cricket Bat	05
4	Leather Ball	10
5	Cork Ball	00
6	Batsman Gloves	02
7	Wicket Keeper Gloves	01
8	Stumps	03
9	Football	02
10	Running Spikes	03
11	Softball Bat	01
12	Knee - Cup	08
13	Anklet	08
14	Softball	01
15	Weight Machin	01
16	Halgı	01
17	Shotput(16 Pound) Icon	02
18	Shotput (16 Pound) Pitalı	01
19	Shotput Icon (12 Pound)	02
20	Shotput - (12 Pound) Pitalı	01
21	Discuss(2 Kg)	01
22	Discuss(1.5 Kg)	01
23	Discuss (1 Kg)	01
24	Hammer	01
25	High Jump Stand	01
26	Take off Board	01
27	Pole Vault Box	01
28	Lazium	00
29	Volleyball Pole	02
30	Tape	01
31	Wooden Cupboard	02



I/C Principal
Karmaveer Mamasahab Jagdale
Mahavidyalaya, Washi.

32	Iron Table	01
33	Javellin	02
34	Carrom Board	01
35	Multi Station Gym	01
36	Weight Training Set 50 Kg	01
37	Bench fall Mult - A	01
38	Parallel Bar	01
39	Horizontal Bar	01
40	Cricket Pad	02
41	Relay Button	04
42	Whistle	02
43	Single Bar	01
44	Hurdles	10
45	Gurad	01
46	High Jump Cross Box	01
47	Stop Watch	01
48	Dumbles 7.5 Kg	01
49	Dumbles 2.5 Kg	01
50	Weight Lifting Bar	01
51	Mask	01
52	Cricket Helmat	02
53	Kho -Kho Pole	01
54	Basket Ball	02
55	Badminton Net	01
56	Track Suit	02
57	Basket Ball Pole	02
58	Throw Ball	02
59	Football Gloves	01
60	Chess Set	04
61	Medals	01

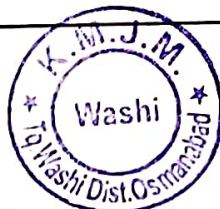

I/C Principal
Karmaveer Mamasahab Jagdale
Mahavidyalaya, Washi,

Annexure I

Rate Conformity Certificate and Abstract of Cost

This is to certify that the estimates for the proposed Construction of ~~Womankh Hostel~~ (Special Scheme) under XII Plan Period at ~~Karmaveer Mamasahab Jagdale Mahavidyalaya, Washi, Dist- Osmanabad- 413503~~ during ~~the XII Plan period~~ is prepared based on Current Schedule of PWD/CPWD ~~in the Washi Region~~ for the year- 2014-15

Signature
Mahesh K. Kulkarni
Consulting Engineer
B.M.C/TP/Reg.No.10/1820/20...

ABSTRACT OF COST

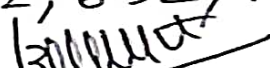
Total built-up area provided in the plans:	306.27 m ²
Total built-up area provided in the plans:	1130.70 m ²
Total built-up area per meter:	10265.53/m ²
	Amount
Total cost of Civil Works	85,30,268/-
(As per current schedule of PWD/CPWD rates)	
a) Water supply & Sanitary installation	6,33,790/-
(@ 7.5% of the civil work cost)	
b) Electrification @10% (without fans) or 12.5% [(with fans),	8,53,027/-
(1.5% for library (with fans) of the civil work cost)	
c) External Services (@5% of the civil work cost)	4,26,513/-
TOTAL:	1,04,49,598/-
d) Contingencies (@3% of a to d above)	3,13,488/-
e) PWD/CPWD Verification Charges	42,652/-
(0.5% of the civil cost) provided plan & estimates have not been prepared by PWD/CPWD Engineers)	



I/C Principal
Karmaveer Mamasahab Jagdale
Mahavidyalaya, Washi.

KARMAVEER MAMASAHEB JAGDALE MAHAVIDYALAYA, WASHI

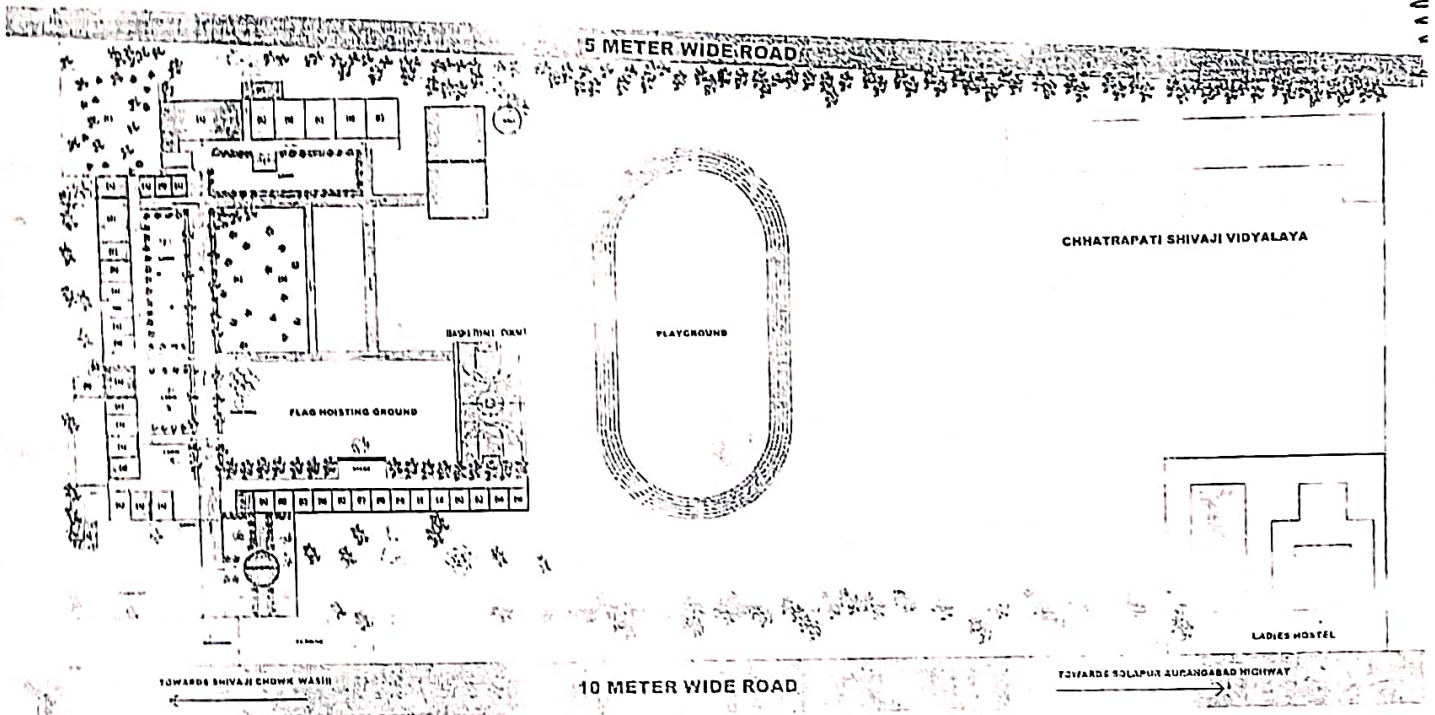

LEGEND	
<p>WAY TO ACCESS THE COLLEGE CAMPUS</p> <p>(A) PRINCIPLE OFFICE (B) VICE PRINCIPLE OFFICE</p> <p>(A) LAUNDS ROOM</p> <p>(A) OFFICE</p> <p>(A) NAAC OFFICE</p> <p>(A) OFFICE</p> <p>(A) MATHEMATICS DEPARTMENT</p> <p>(A) GUEST HOUSE</p> <p>(A) ZOOLOGY DEPARTMENT (B) ZOOLOGY DEPARTMENT</p> <p>(A) PHYSICS DEPARTMENT (B) PHYSICS DEPARTMENT</p> <p>(A TO D) CHEMISTRY DEPARTMENT</p>	<p>(A) LIBRARY</p> <p>(A) INDOOR GAMES AREA</p> <p>(A) GENERATOR ROOM</p> <p>(A) KARMAVEER MAMASAHEB JAGDALE MEMORIAL</p> <p>(A) PARKING</p> <p>(A) PASSAGE</p> <p>(A) PLAYGROUND</p> <p>(A) MEDICINAL PLANT (B) VERMICULTURE PROJECT (C) BOTANICAL GARDEN</p> <p>(A) GENTS URINAL (B) GENTS TOILET (C) LADIES TOILET</p> <p>(A) BASKETBALL COURT</p> <p>(A AND B) BOYS HOSTEL (C TO M) CLASSROOM (N) STAFF ROOM</p>



[Signature]
T/C Principal
Karmaveer Mamasahab Jagdale
Mahavidyalaya, Washi.

THE DRAWING BY: ANKITA ARUN KUMHAR

Credit Memo

॥ श्री गिरीधरिनाथक प्रसाद ॥



PRIYANKA

S P O R T S

Date 09/11/2012

Bill No. 932

Supplier and Dealers in Disabled Rehabilitation Products, Sports & Health Care Equipments

Harshwardhan Towers, 84, Railway Lines, Opp Old R.T.O., Solapur. Mo. 9422067437, 9421032857

Principal, Karmaveer Mamasahab Jagdale Mahavidyalaya,
Washi, Tq. Washi Dist. - Osmanabad.

No.	DESCRIPTION	QTY.	MRP	RATE	Disc.	AMOUNT Rs.
1	Hydrolic Basketball Goalpost with 20mm. Acrylic Board foldable & Movable	01 set				5,00,000
						(Rupees Five Lakh only)

[Signature]
प्राचार्य

कर्मवीर मासासाहेब जगदाले महाविद्यालय
वाशी ता. वाशी जि. अहमदनगर

VAT TIN NO. 27900358644 V w.e.f. 1/4/2006
CST TIN NO. 27900358644 C w.e.f. 1/4/2006

TOTAL 5,00,00

I/We hereby certify that our registration certificate under the Maharashtra Value Added Tax Act, 2002 is in force on the date on which the sale of the goods specified in this tax invoice is made and that transaction of sale covered by this tax invoice has been effected by me/us and it shall be accounted for in the turnover of sales while filing of return and the due tax, if any, paid thereon has been paid or shall be paid.

E & O E

Terms & Conditions 1) Goods once Sold will not be taken back.
2) All products bear warranty against manufacturing defects and operation as per standard test conditions.
Office: M.G.Nagar, Naikwadi Plot, Barshi, Dist Solapur

Customer's Sign

For Priyanka

C.N.O - 91490 (C.N.O 91491 - 5-12-11)
2012

Terms and Conditions:

- 1) Above rates are including VAT Tax, Transport, Installation etc.
- 2) Advance payment 75% with order and balance 25% on inspection and delivery.
- 3) Delivery 45 days from date of confirmed order.
- 4) Goods made to order are not returnable.
- 5) Warranty is for 12 months against manufacturing defects and electronic parts only.

Thanking you and assuring you at our best attention and services at all time.



Karmaveer

I/C Principal
Mamasahab Jagdale
Mahavidyalaya, Washi.



Yours sincerely

[Signature]
प्राचार्य 30/10/12

For Priyanka Sports

I/C Principal
Karmaveer Mamasahab Jagdale
Mahavidyalaya, Washi.

M/s. PACHKAWADE & ASSOCIATES.

Architect Engineers.

(CA - 17978)

57 E. Ramlal Chowk, Solapur - 1

Tel - 2620429. M. No - 9822047538.

E - mail :- call vrp@rediffmail.com

Ref.No -

Date - / / 2012

ESTIMATE

Name of Work :- Proposed Constriction of Gymnasium Hall Building
In C.T.S No - 18/1 At Karmveer Mamasahab Jagdale
Mahavidyalaya Washi, Dist - Osmanabad. For Shri Shivaji
Shikshan Prasharak Mandal, Barshi.

Name of Owner :- The Chairman
Shri Shivaji Shikshan Prasharak Mandal, Barshi.

Estimate Cost :- Rs - 80,24,518.00

(In word Rs - Eighty Lacs Twenty Four Thousand
Five Hundred Eighteen Only]

Estimate Rates :- As per Market Rate - 2011-12

Estimate Prepared by :- Shri - Pachkawade. S. R.

Estimate Prepared In office of :- M/s PACHKAWADE AND ASSOCIATES
SOLAPUR.

Mahajan
Sub-Divisional Engineer
Special Project Sub-Division No. 2
Washi



[Signature]
I/C Principal
Karmaveer Mamasahab Jagdale
Mahavidyalaya, Washi.



[Signature]
I/C Principal
Karmaveer Mamasahab Jagdale
Mahavidyalaya, Washi.

GURUKULONLINE LEARNING SOLUTIONS PVT LTD

Shree Krishna Niwas, Shradhanand Road Extn.,
Vile Parle (East), Mumbai - 400 057
Maharashtra, India
Tel : +91 - 22 - 2614 1111 / Fax : + 91 - 22 - 2614 1111 - Extn : 102

INVOICE

To,
Shri Shivaji Shikshan Prasarak Mandals
Karmaveer Mamasahab Jagdale Mahavidyala
Washi Dist., Osmanabad (Maharashtra)

Corporate Solutions :: Academy :: University & Institution Solutions

GOLS™

Shree Krishna Niwas, Shradhanand Road Extn., Vile Parle (E), Mumbai - 400 057, India.
Ph.: +91-22-33097600, Fax: 33097600, Extn.: 102, www.gols.in

8411

Receipt No. _____

Date: 24/6/2013

Received with thanks from Mr./Ms. Karmaveer Mamasahab Jagdale Mahavidyalaya

the sum of Rupees fifty three thousand ninety only

vide Cash / Cheque No./D.D. No. 411360 dated 06.6.2013

on Bank Maharashtra Gramin Bank Branch Washi Dist. Osmanabad

towards the course GOLS Language Lab. (Advance pack)

Rs. 53090/-

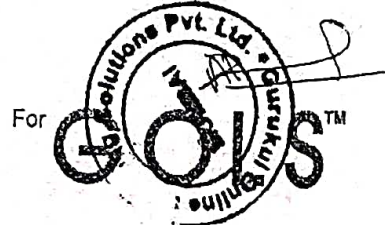

Your account will be activated within 3 days of cheque realization.

BANK NAME : HDFC BANK LIMITED
IFSC CODE : HDFC0000114
BANK BRANCH : ANDHERI (WEST), MUMBAI - 400 058

Authorized Signatory

प्राचार्य
कर्मवीर मामासाहेब जगदाळे महाविद्यालय
वाशी ता.वाशी जि.उस्मानाबाद



Bullu
I/C Principal
Karmaveer Mamasahab Jagdale
Mahavidyalaya, Washi.

www.gols.in

[Signature]
I/C Principal
Karmaveer Mamasahab Jagdale
Mahavidyalaya, Washi.

GURUKULONLINE LEARNING SOLUTIONS PVT LTD

Shree Krishna Niwas, Shraddhanand Road Extn.,
Vile Parle (East), Mumbai - 400 057
Maharashtra, India
Tel : +91 - 22 - 2614 1111 / Fax : + 91 - 22 - 2614 1111 - Extn : 102

INVOICE

To,
Shri Shivaji Shikshan Prasarak Mandals
Karmaveer Mamasahab Jagdale Mahavidyala
Washi Dist., Osmanabad (Maharashtra)

INVOICE #	INVOICE DATE	ORDER NO. & DATE		
2012-2013/018	28.05.2013	P.O. # 2012-2013/276 dated 24.04.2013		
Sr. #	Description	Nos	Rate (Rs.)	Amount (Rs.)
1	GOLS British English (Advance) Pack	10	4,500.00	45,000
Total Amount				45,000
Add: VAT 5%				2,250
Add : Service Tax 12.36%				5,840
Grand Total Amount				53,090

Amount in Words: Rupees Fifty Three Thousand Ninety Only

Invoice Tax Reg. # : MIV / ST / OLS / 96 / AACCG0506GST001
Invoice Tax Category - Online Information & Data
TIN # : 27410746283 V W.E.F.: 26/01/2010 and CST TIN # : 27410746283C W.E.F.: 26/01/2010
I # AACCG0506G

TERMS & CONDITIONS
All Payments to be made in favor of "GurukulOnline Learning Solutions Pvt Ltd."
Payments to be made within 30 Days of the submission of the Invoice
All Claims and dispute will be subject to MUMBAI JURISDICTION

Account Details For All Transactions
ACCOUNT NO. : 01142000002697
ACCOUNT NAME : GURUKULONLINE LEARNING SOLUTIONS PVT LTD
BANK NAME : HDFC BANK LIMITED
IFSC CODE : HDFC0000114
BANK BRANCH : ANDHERI (WEST), MUMBAI - 400 058

For GurukulOnline Learning Solutions Pvt. Ltd.



Authorized Signatory

प्राचार्य

कर्मवीर मामासाहेब जगदाले महाविद्यालय
वाशी ता.वाशी जि.उस्मानाबाद



I/C Principal
Karmaveer Mamasahab Jagdale
Mahavidyalaya, Washi. www.gols.l

I/C Principal
Karmaveer Mamasahab Jagdale
Mahavidyalaya, Washi.